

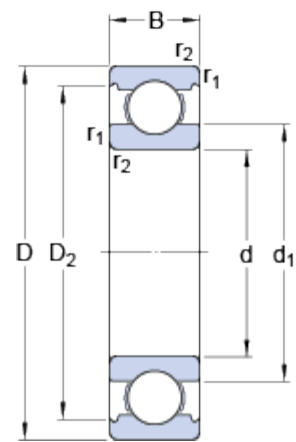

# 6301

Popular item  
SKF Explorer

## Dimensions



d	12	mm
D	37	mm
B	12	mm
d <sub>1</sub>	≈ 19.51	mm
D <sub>2</sub>	≈ 31.48	mm
r <sub>1,2</sub>	min. 1	mm

## Abutment dimensions

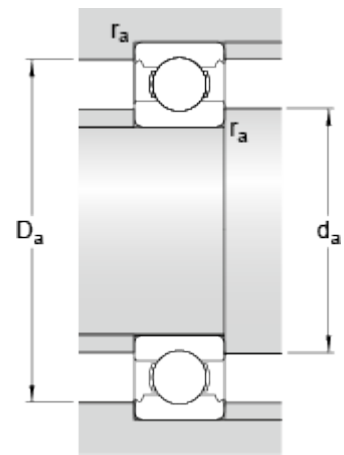

d <sub>a</sub>	min. 17.6	mm
D <sub>a</sub>	max. 31.4	mm
r <sub>a</sub>	max. 1	mm

## Calculation data

Basic dynamic load rating	C	10.1	kN
Basic static load rating	C <sub>0</sub>	4.15	kN
Fatigue load limit	P <sub>u</sub>	0.176	kN
Reference speed		45000	r/min
Limiting speed		28000	r/min
Calculation factor	k <sub>r</sub>	0.03	
Calculation factor	f <sub>0</sub>	11	

## Mass

Mass bearing	0.059	kg
--------------	-------	----