

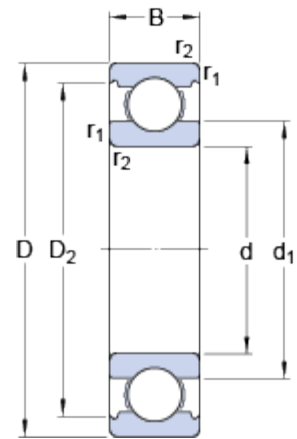

# 6011

Popular item  
SKF Explorer

## Dimensions



d	55	mm
D	90	mm
B	18	mm
d <sub>1</sub>	≈ 66.3	mm
D <sub>2</sub>	≈ 81.5	mm
r <sub>1,2</sub>	min. 1.1	mm

## Abutment dimensions

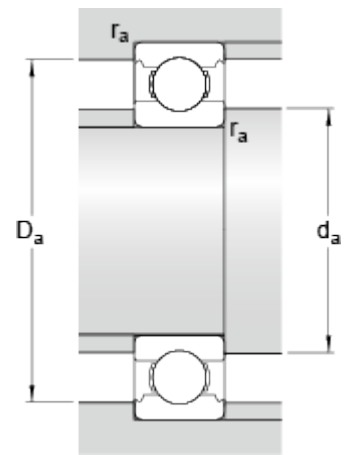

d <sub>a</sub>	min. 61	mm
D <sub>a</sub>	max. 84	mm
r <sub>a</sub>	max. 1	mm

## Calculation data

Basic dynamic load rating	C	29.6	kN
Basic static load rating	C <sub>0</sub>	21.2	kN
Fatigue load limit	P <sub>u</sub>	0.9	kN
Reference speed		16000	r/min
Limiting speed		10000	r/min
Calculation factor	k <sub>r</sub>	0.025	
Calculation factor	f <sub>0</sub>	15.4	

## Mass

Mass bearing	0.38	kg
--------------	------	----