

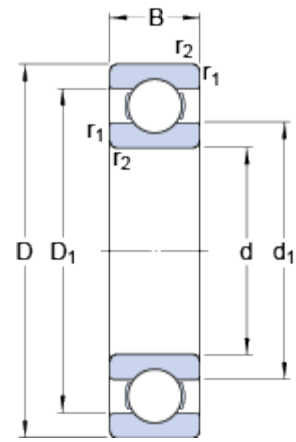

61815

Popular item

Dimensions



d	75	mm
D	95	mm
B	10	mm
d ₁	≈ 81.7	mm
D ₁	≈ 88.7	mm
D ₂	≈ 90.7	mm
r _{1,2}	min. 1.3	mm

Abutment dimensions

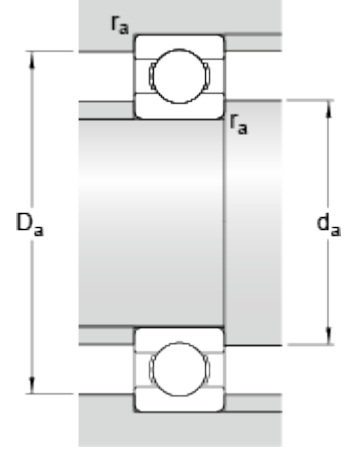

d _a	min. 78.2	mm
D _a	max. 91.8	mm
r _a	max. 0.6	mm

Calculation data

Basic dynamic load rating	C	12.5	kN
Basic static load rating	C ₀	10.8	kN
Fatigue load limit	P _u	0.585	kN
Reference speed		14000	r/min
Limiting speed		8500	r/min
Calculation factor	k _r	0.015	
Calculation factor	f ₀	13.4	

Mass

Mass bearing		0.14	kg
--------------	--	------	----