

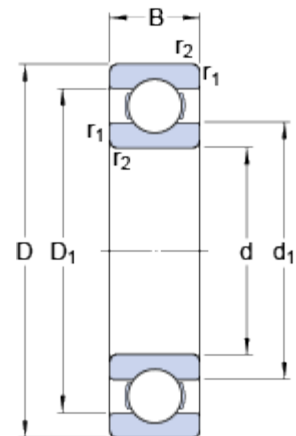

61911

Popular item

Dimensions



d	55	mm
D	80	mm
B	13	mm
d ₁	≈ 63	mm
D ₁	≈ 72.3	mm
r _{1,2}	min. 1	mm

Abutment dimensions

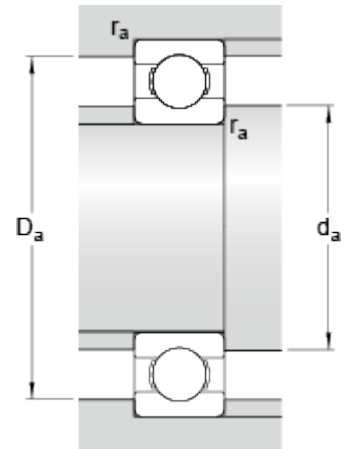

d _a	min. 59.6	mm
D _a	max. 75.4	mm
r _a	max. 1	mm

Calculation data

Basic dynamic load rating	C	16.5	kN
Basic static load rating	C ₀	14	kN
Fatigue load limit	P _u	0.6	kN
Reference speed		17000	r/min
Limiting speed		11000	r/min
Calculation factor	k _r	0.02	
Calculation factor	f ₀	16.3	

Mass

Mass bearing	0.19	kg
--------------	------	----