

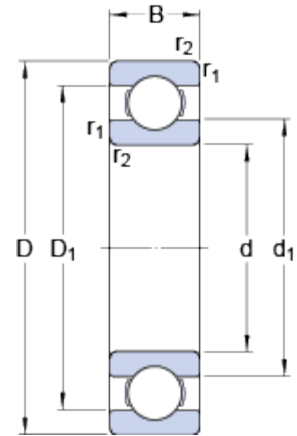

61913

Popular item

Dimensions



d	65	mm
D	90	mm
B	13	mm
d ₁	≈ 73	mm
D ₁	≈ 82.3	mm
D ₂	≈ 84.2	mm
r _{1,2}	min. 1	mm

Abutment dimensions

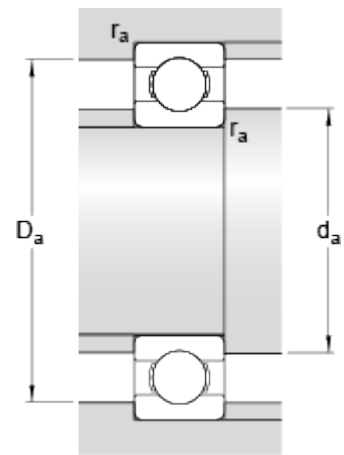

d _a	min. 69.6	mm
D _a	max. 85.4	mm
r _a	max. 1	mm

Calculation data

Basic dynamic load rating	C	17.4	kN
Basic static load rating	C ₀	16	kN
Fatigue load limit	P _u	0.68	kN
Reference speed		15000	r/min
Limiting speed		9500	r/min
Calculation factor	k _r	0.02	
Calculation factor	f ₀	16.6	

Mass

Mass bearing		0.2	kg
--------------	--	-----	----