

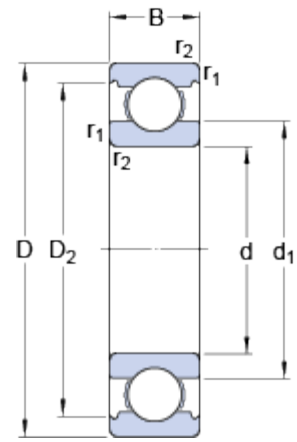

61914

Popular item

Dimensions



d	70	mm
D	100	mm
B	16	mm
d ₁	≈ 79.8	mm
D ₂	≈ 92.9	mm
r _{1,2}	min. 1	mm

Abutment dimensions

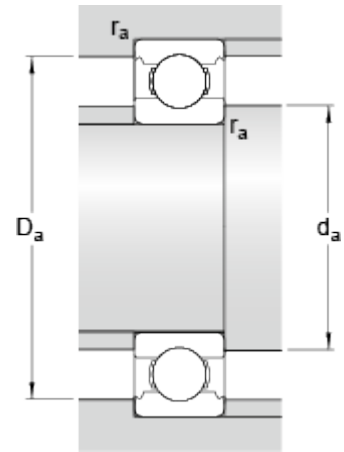

d _a	min. 74.6	mm
D _a	max. 95.4	mm
r _a	max. 1	mm

Calculation data

Basic dynamic load rating	C	23.8	kN
Basic static load rating	C ₀	18.3	kN
Fatigue load limit	P _u	0.9	kN
Reference speed		14000	r/min
Limiting speed		8500	r/min
Calculation factor	k _r	0.02	
Calculation factor	f ₀	14.1	

Mass

Mass bearing	0.34	kg
--------------	------	----