

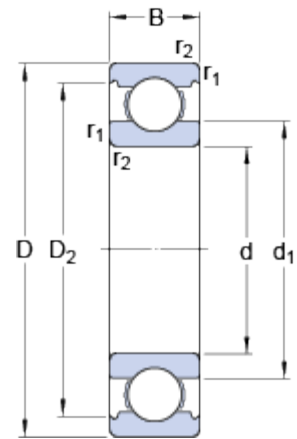

61916

Popular item

Dimensions



d	80	mm
D	110	mm
B	16	mm
d ₁	≈ 89.8	mm
D ₂	≈ 102.2	mm
r _{1,2}	min. 1	mm

Abutment dimensions

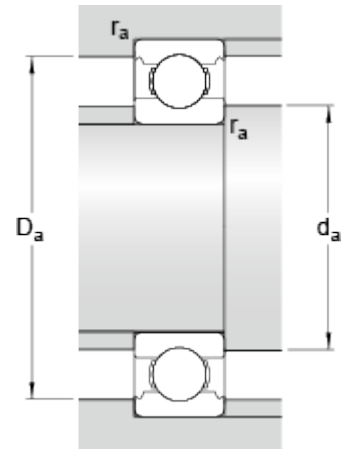

d _a	min. 84.6	mm
D _a	max. 105	mm
r _a	max. 1	mm

Calculation data

Basic dynamic load rating	C	25.1	kN
Basic static load rating	C ₀	20.4	kN
Fatigue load limit	P _u	1.02	kN
Reference speed		12000	r/min
Limiting speed		7500	r/min
Calculation factor	k _r	0.02	
Calculation factor	f ₀	14	

Mass

Mass bearing	0.38	kg
--------------	------	----