

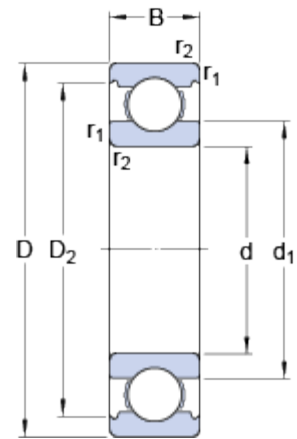

# 6218

Popular item  
SKF Explorer

## Dimensions



d	90	mm
D	160	mm
B	30	mm
d <sub>1</sub>	≈ 112.5	mm
D <sub>2</sub>	≈ 142.6	mm
r <sub>1,2</sub>	min. 2	mm

## Abutment dimensions

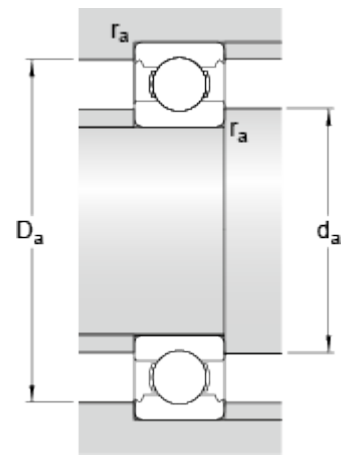

d <sub>a</sub>	min. 101	mm
D <sub>a</sub>	max. 149	mm
r <sub>a</sub>	max. 2	mm

## Calculation data

Basic dynamic load rating	C	101	kN
Basic static load rating	C <sub>0</sub>	73.5	kN
Fatigue load limit	P <sub>u</sub>	2.8	kN
Reference speed		8500	r/min
Limiting speed		5300	r/min
Calculation factor	k <sub>r</sub>	0.025	
Calculation factor	f <sub>0</sub>	14.7	

## Mass

Mass bearing	2.22	kg
--------------	------	----